



Goodfellows
estate agents.com

59
Whittingham Road
Newcastle upon
Tyne
NE5 4DL

59 Whittingham Road
Westerhope
Newcastle upon Tyne
NE5 4DL



£65,000

50% shared ownership of a 3 bedroom semi detached house with no upper chain involved, driveway and rear garden, in a cul-de-sac location



Ground Floor

Approx. 41.5 sq. metres (446.8 sq. feet)

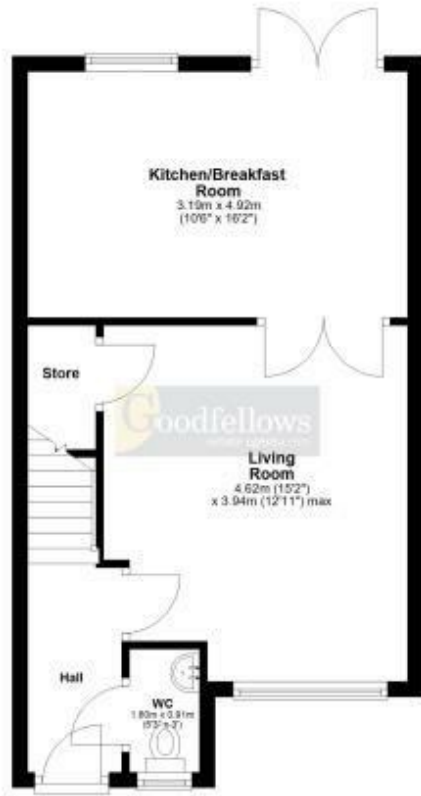

First Floor

Approx. 38.9 sq. metres (418.3 sq. feet)

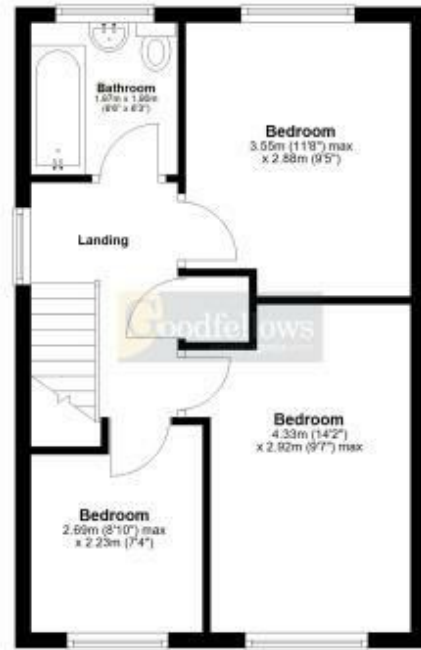

Total area: approx. 80.4 sq. metres (865.1 sq. feet)

Whilst every attempt has been made to ensure the accuracy of the floor plan contained here, measurements of doors, windows, rooms and any other items are approximate and no responsibility is taken for any error, omission, or mis-statement. The Plan is for illustrative purposes only.
Version 1

Plan produced using PlanUp.

Energy Efficiency Rating		Current	Potential
<i>Very energy efficient - lower running costs</i>			
(92 plus) A			
(81-91) B			
(69-80) C		74	80
(55-68) D			
(39-54) E			
(21-38) F			
(1-20) G			
<i>Not energy efficient - higher running costs</i>			
England & Wales	EU Directive 2002/91/EC		

EPC Rating: C
Council Tax Band: A

DIRECTIONS

CONTACT

128 The Roman Way
West Denton
Newcastle upon Tyne
NE5 5AD

E: westdenton@goodfellowsestateagents.com

T: 0191 2677500

<https://www.goodfellowsestateagents.com/>

